

# Broadmoor Neighborhood



# **Project Goals**

- **Beautify Treat Path and improve safety at path road crossings.**
- **Celebrate the Treat Path and Arroyo Chico Crossings as a neighborhood places.**
- **Reinforce neighborhood identity.**

**Issues: Identity & Character, Spaces & Places, Safety**

# Identity and Character



# Spaces and Places



# Safety



# Safety



# Right-of-Ways, Easements

**Right-of-ways are City-owned corridors and are in the public domain.**

**Easements are portions of privately owned land where permission for only a specific use has been granted, such as utility access.**



# Master Plan

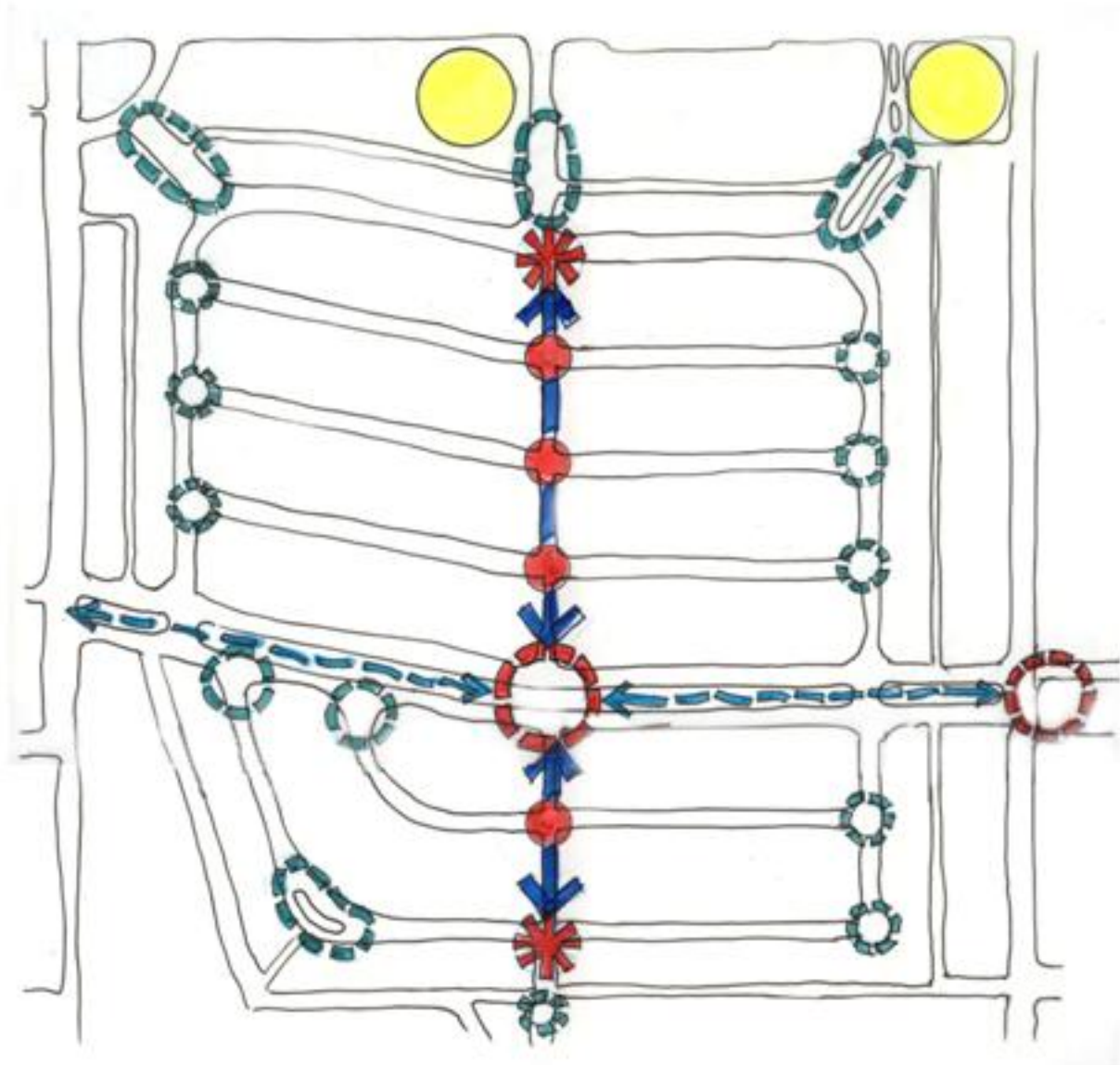

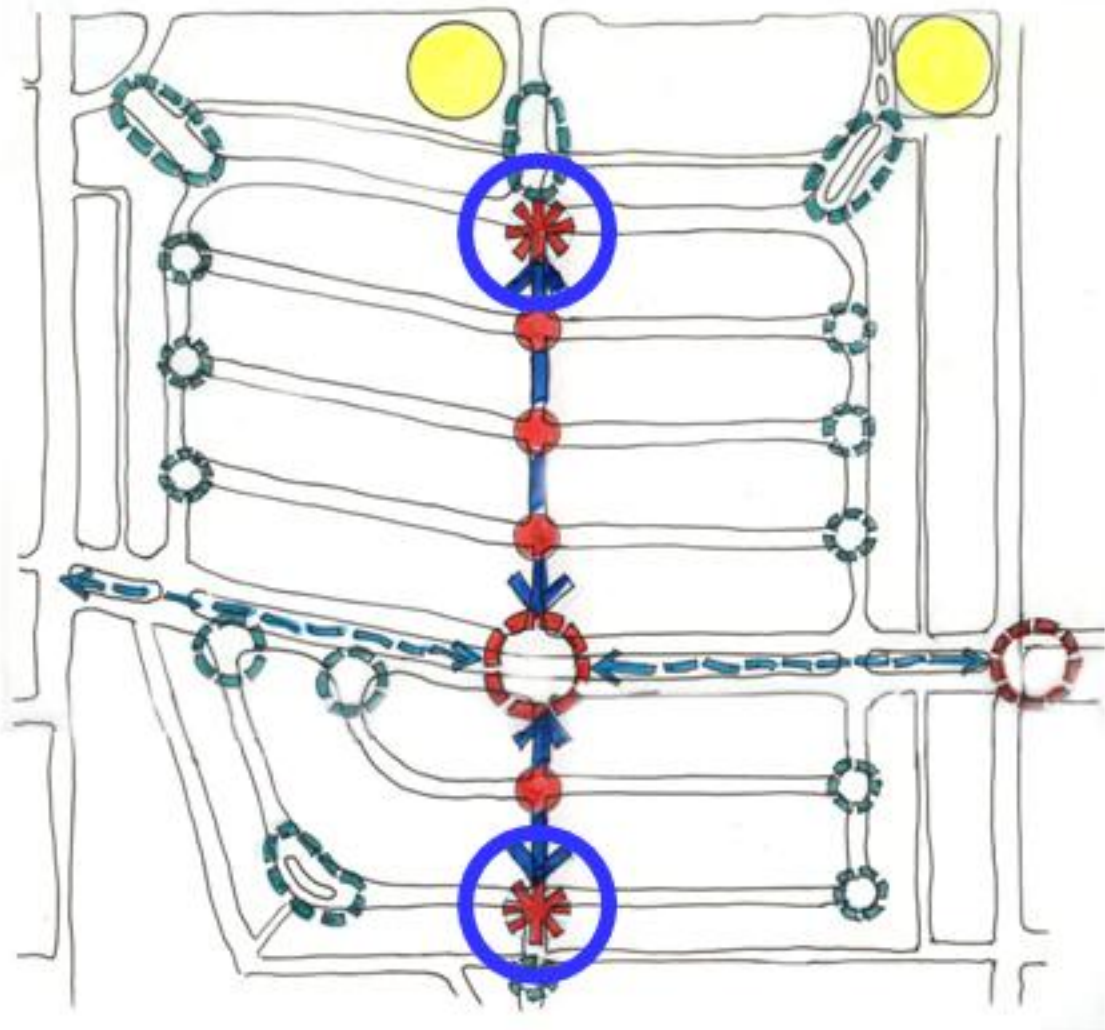

# Path Gateways

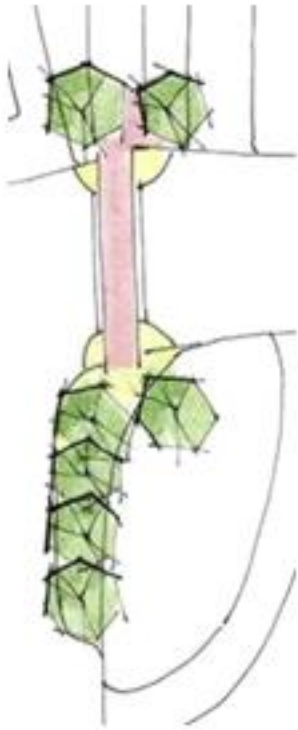

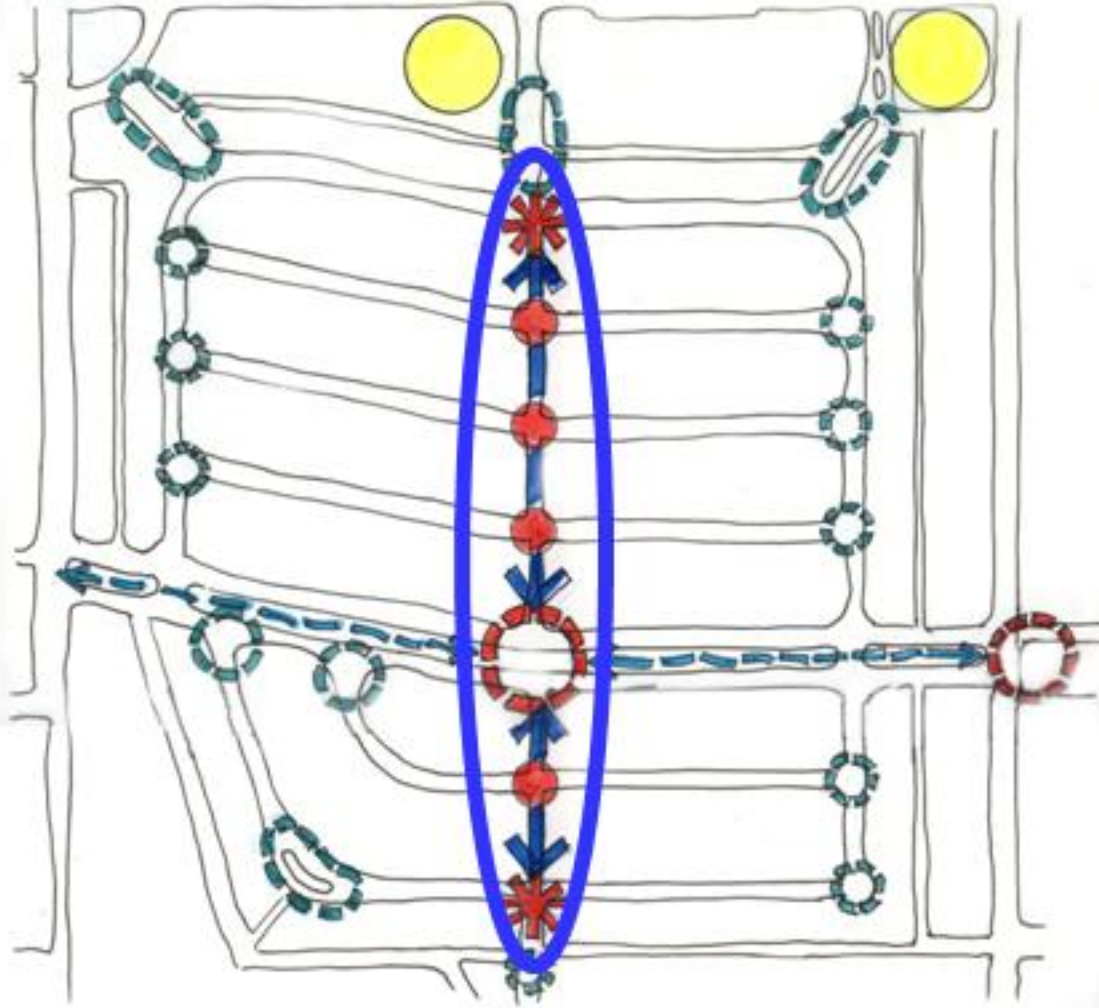

# Walkway Enhancements

## Defining the path



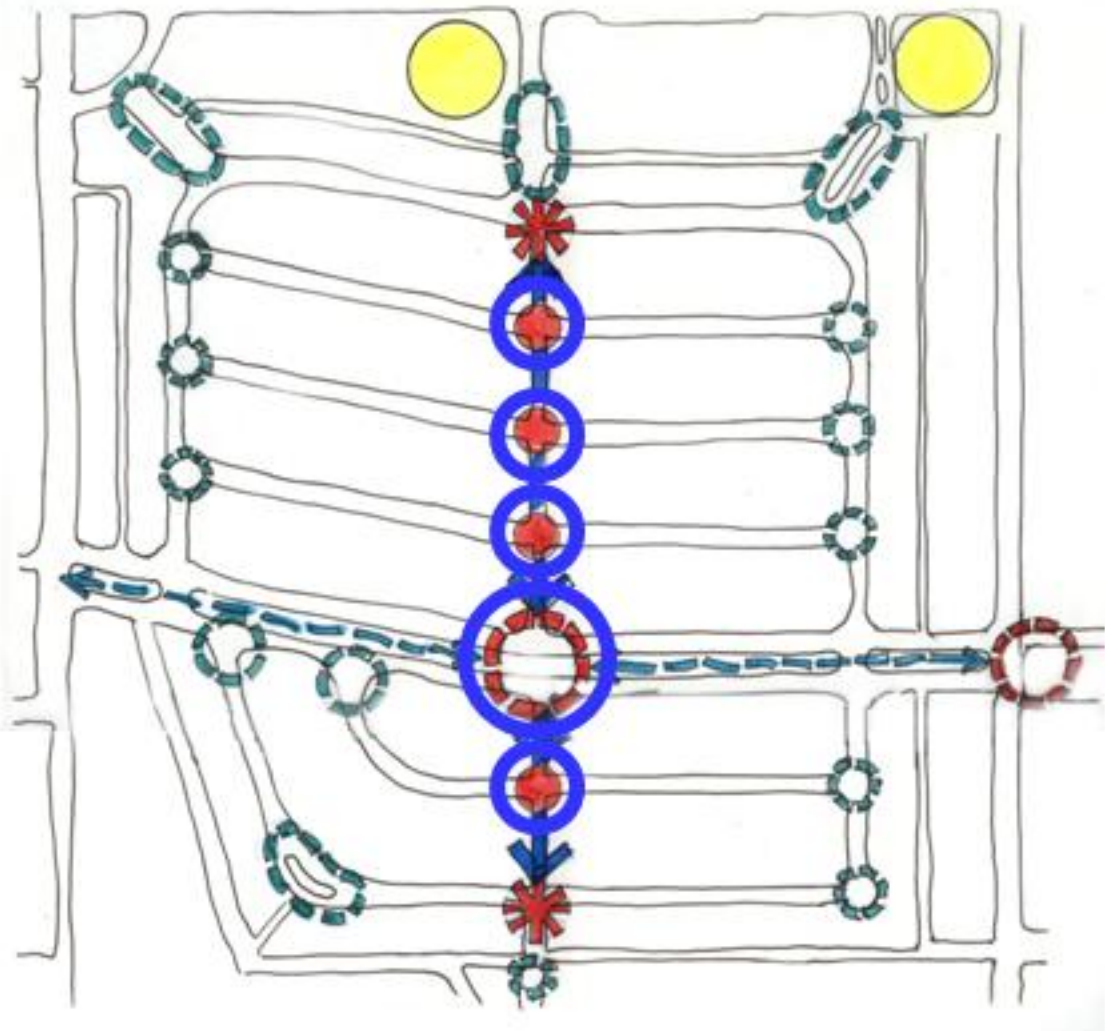

# Path Crossings

## Marked crossing

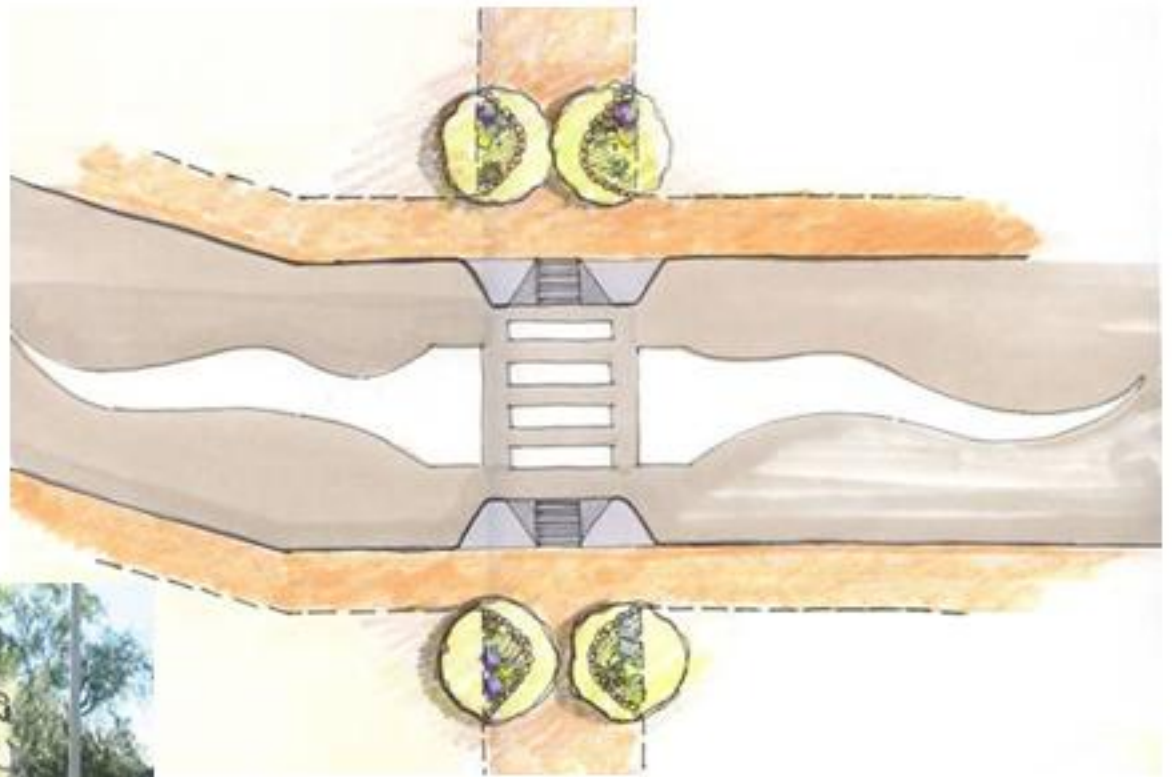

# Path Crossings

## Yield-flow pedestrian table

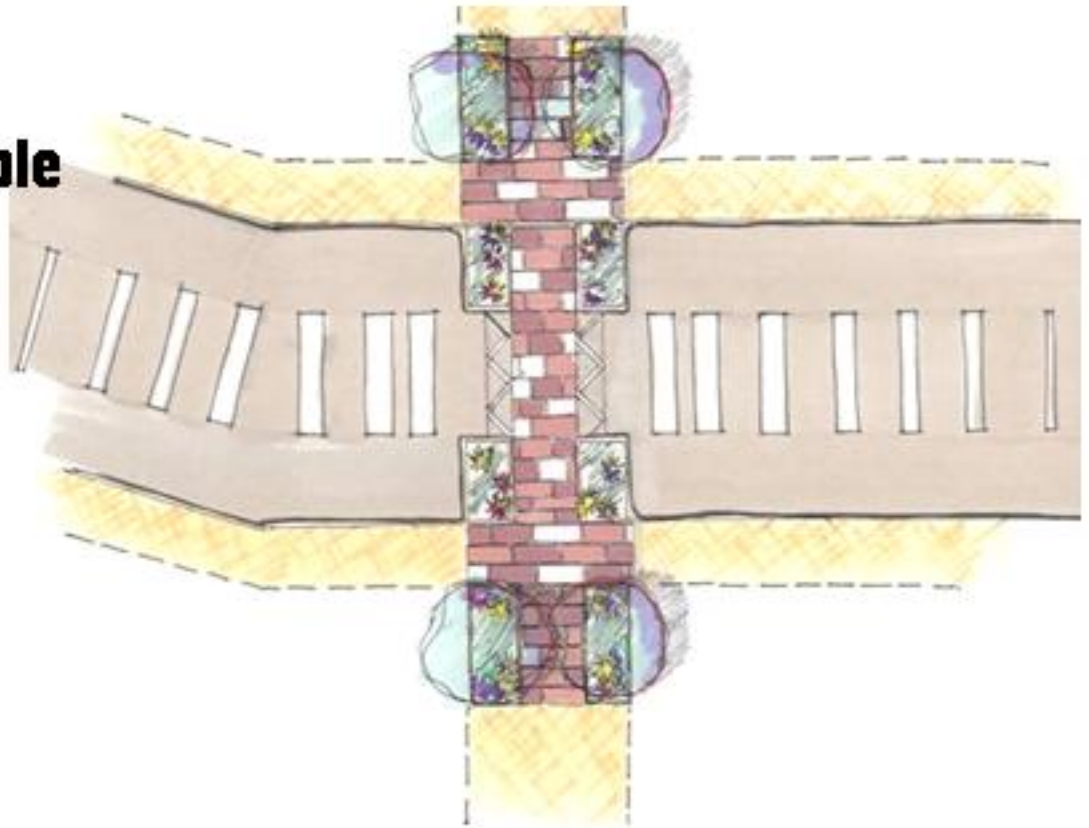

# Path Crossings

## Offset pedestrian table

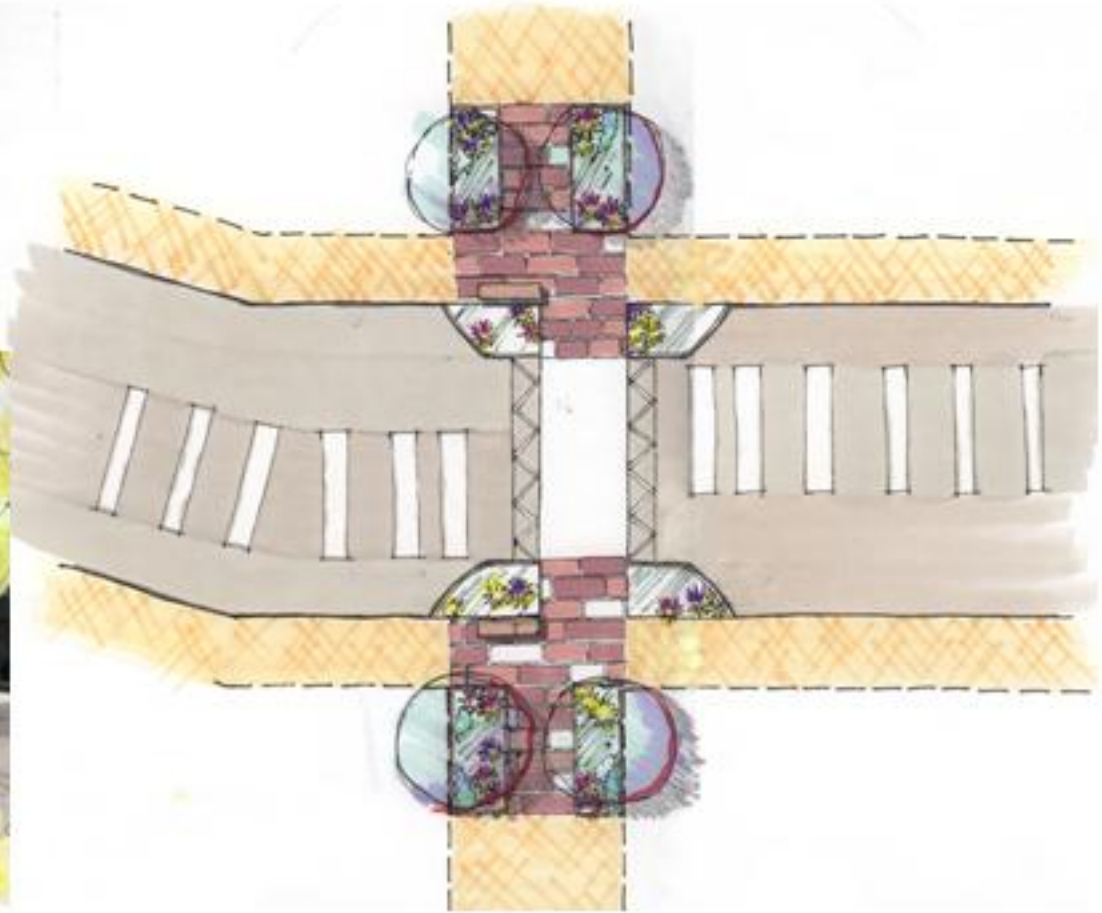

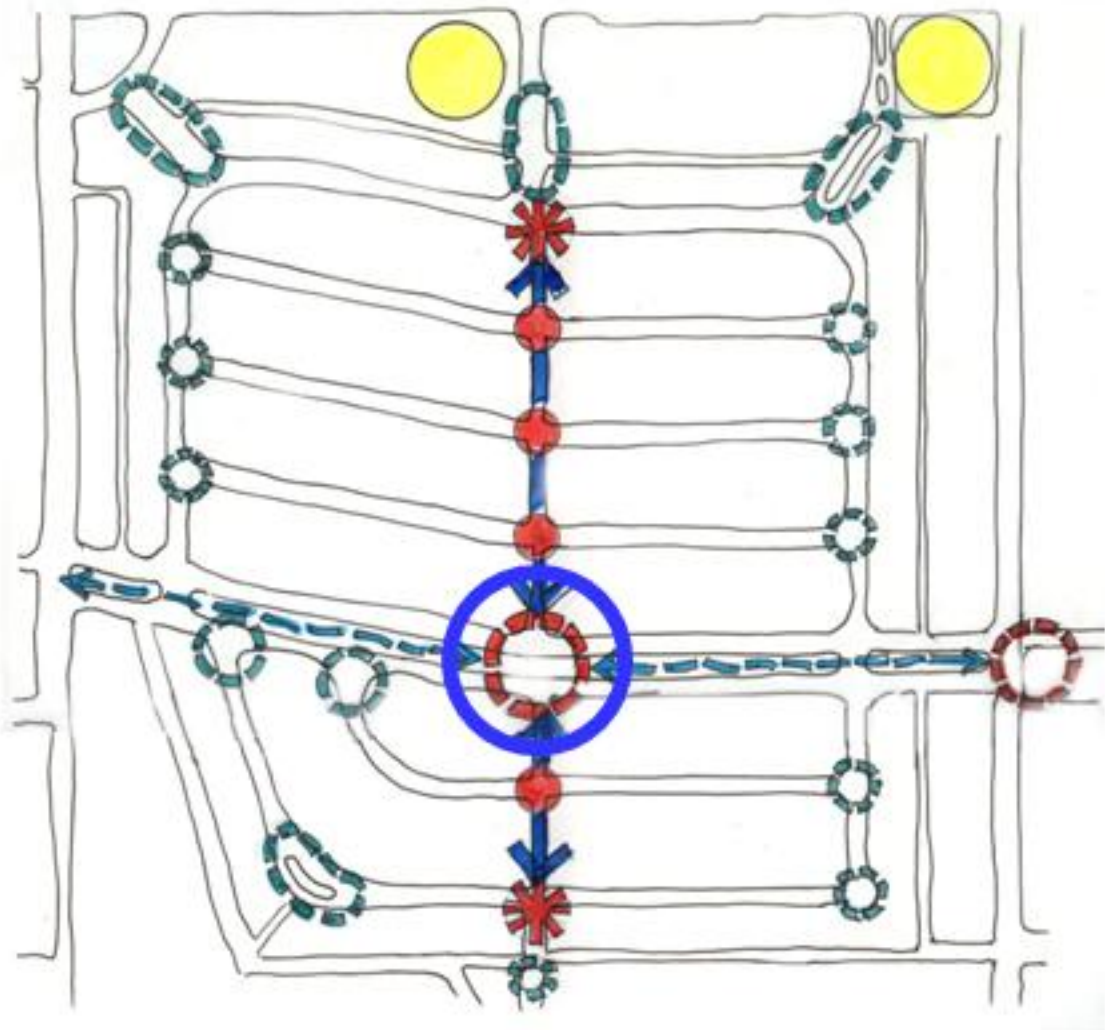

# Bridge Crossing Concept 1

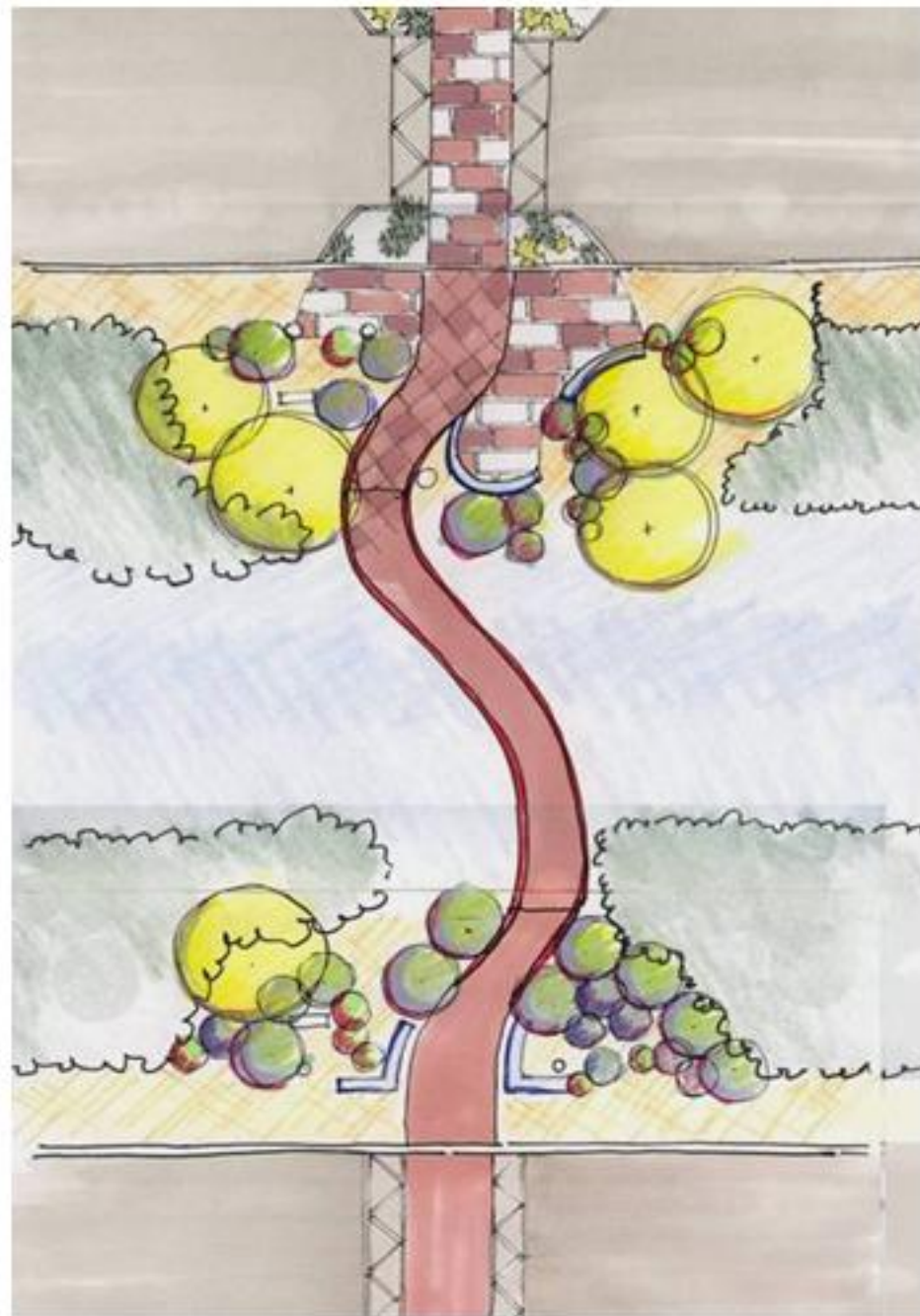

# Bridge Crossing Concept 2

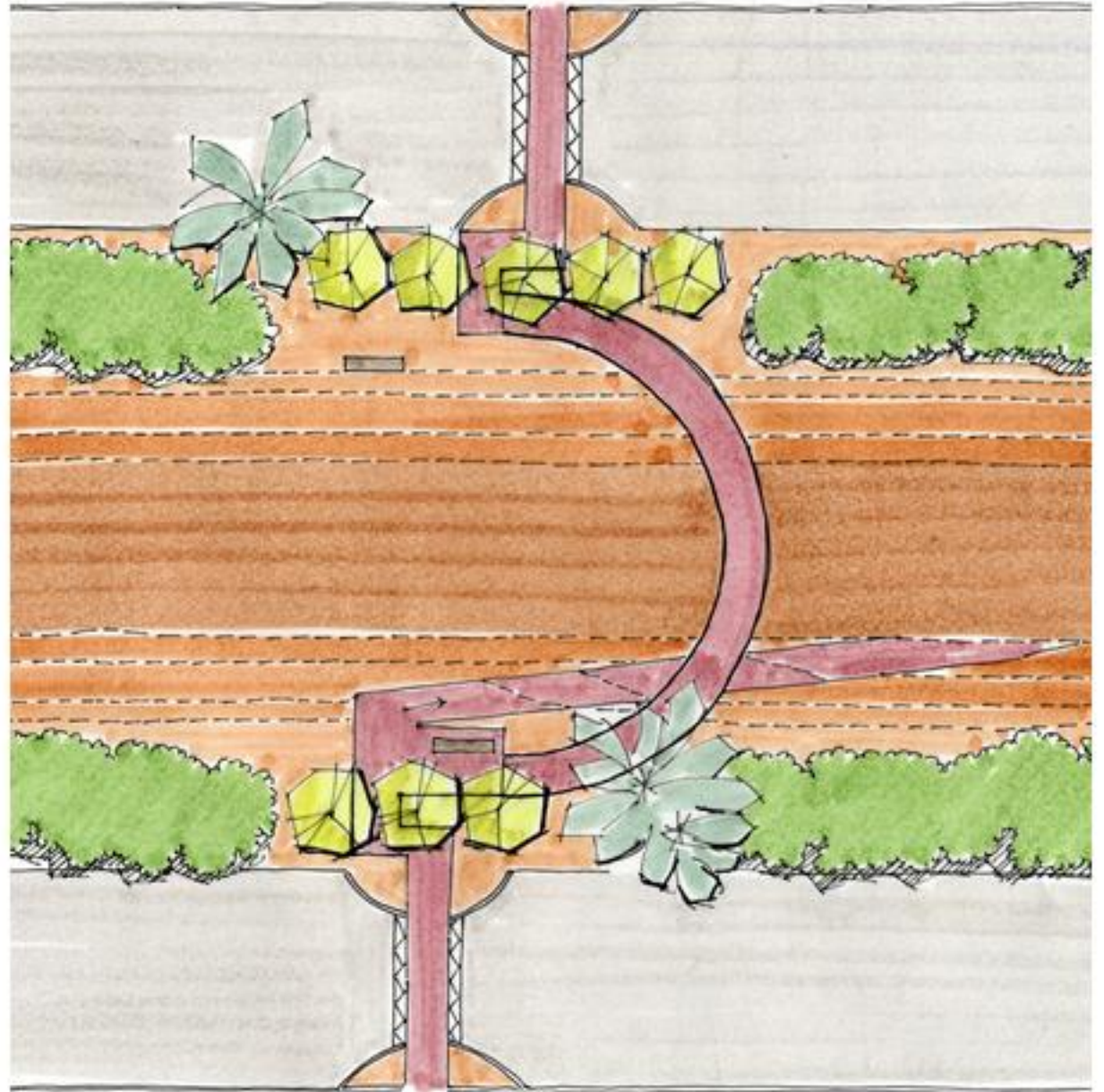

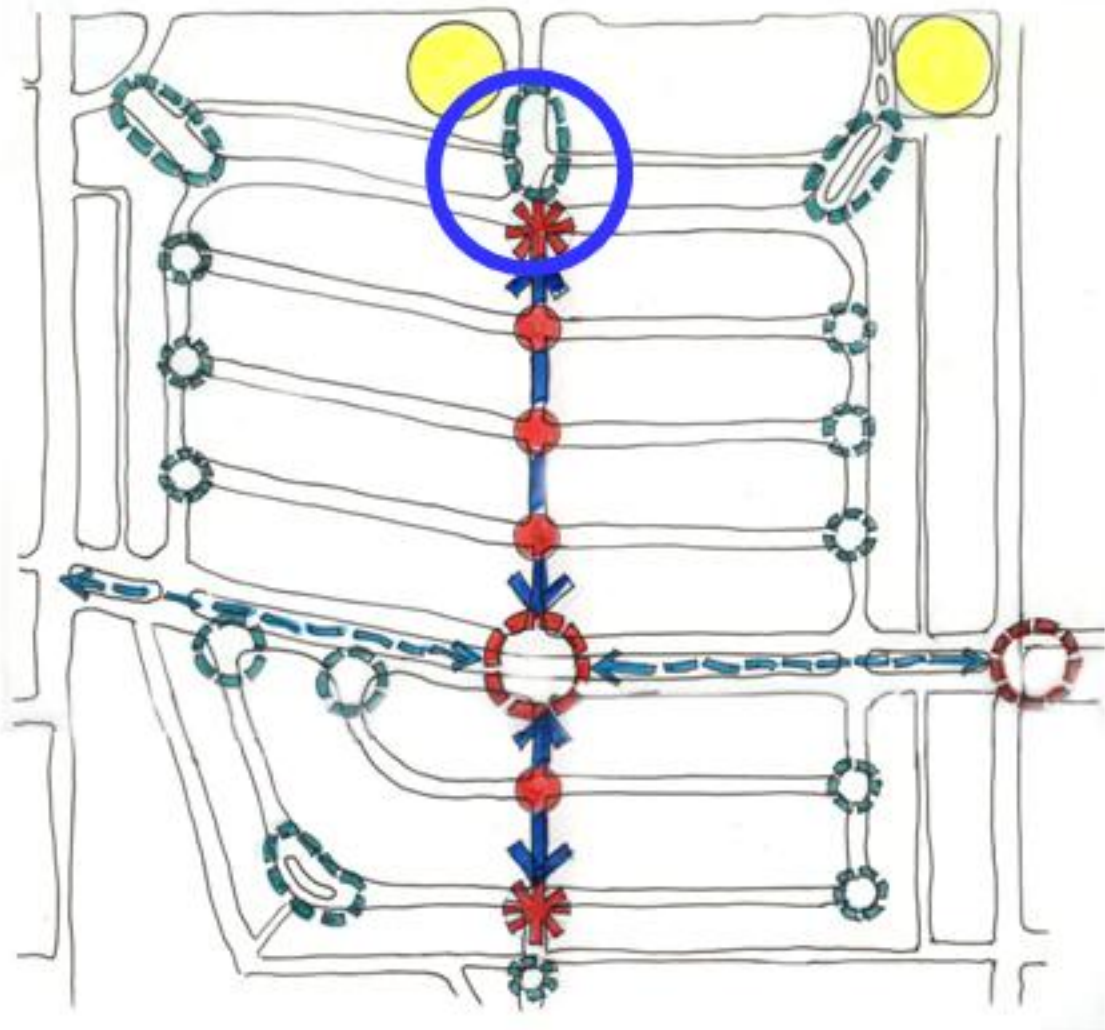

# Neighborhood Gateway – Treat Ave.



2



3



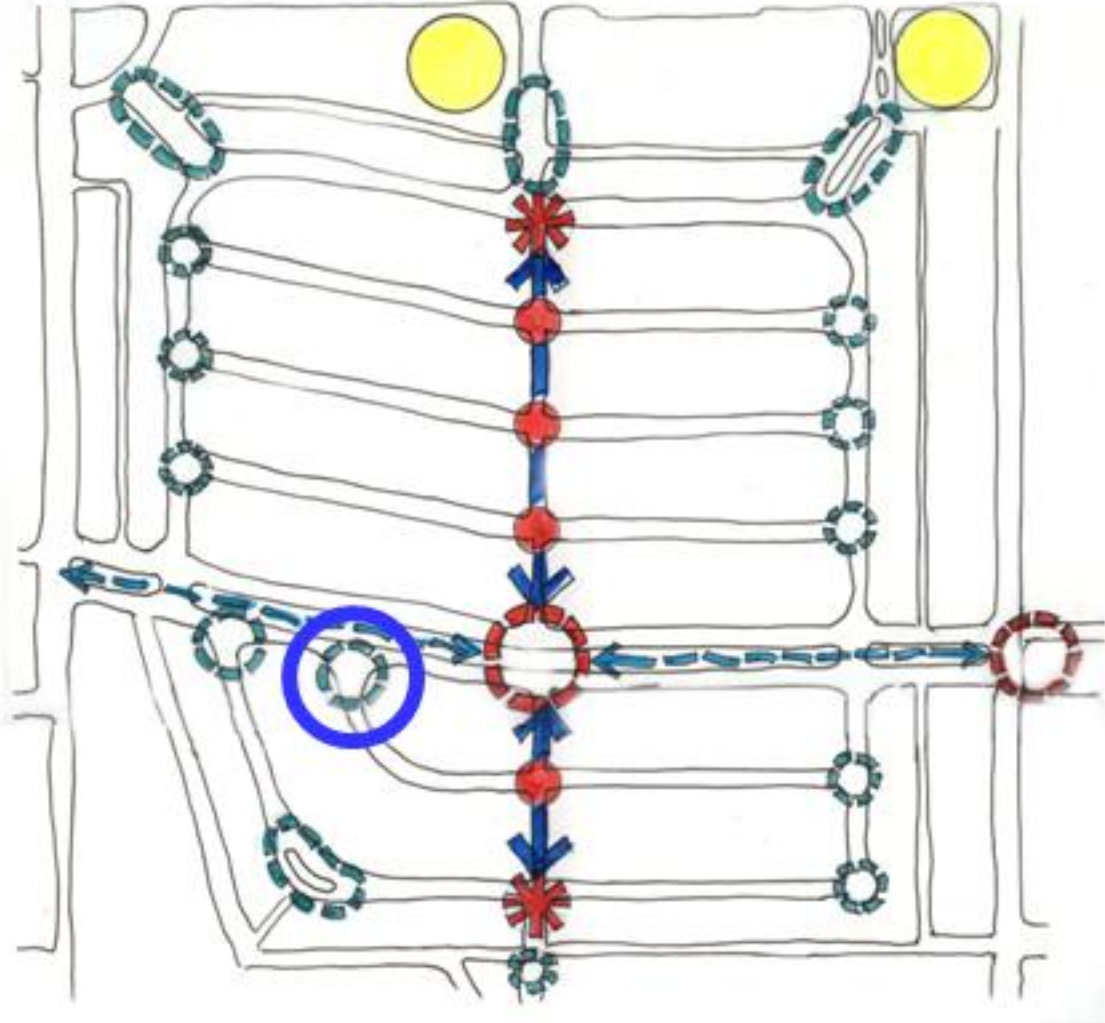

# Gathering Place – Malvern St.

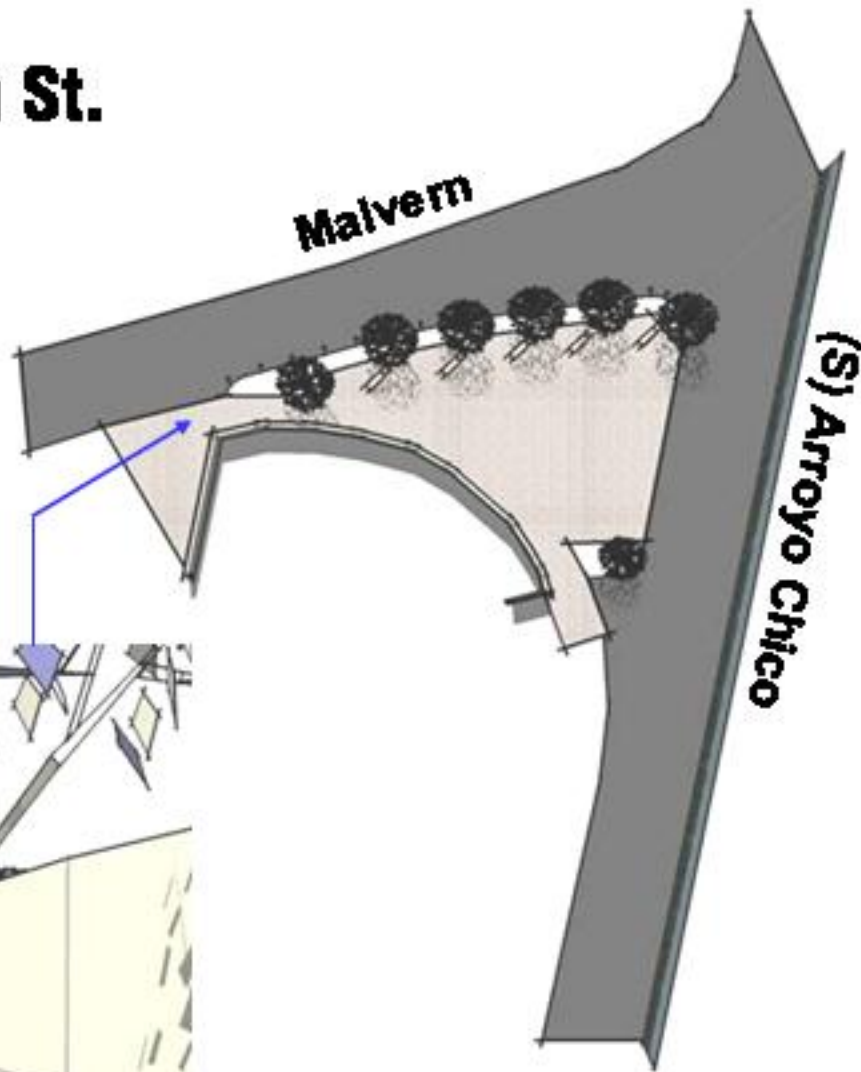

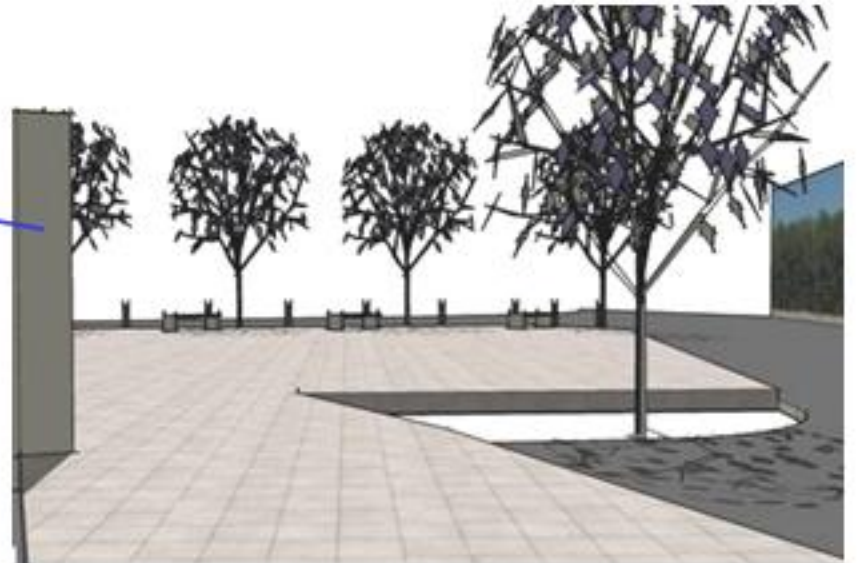
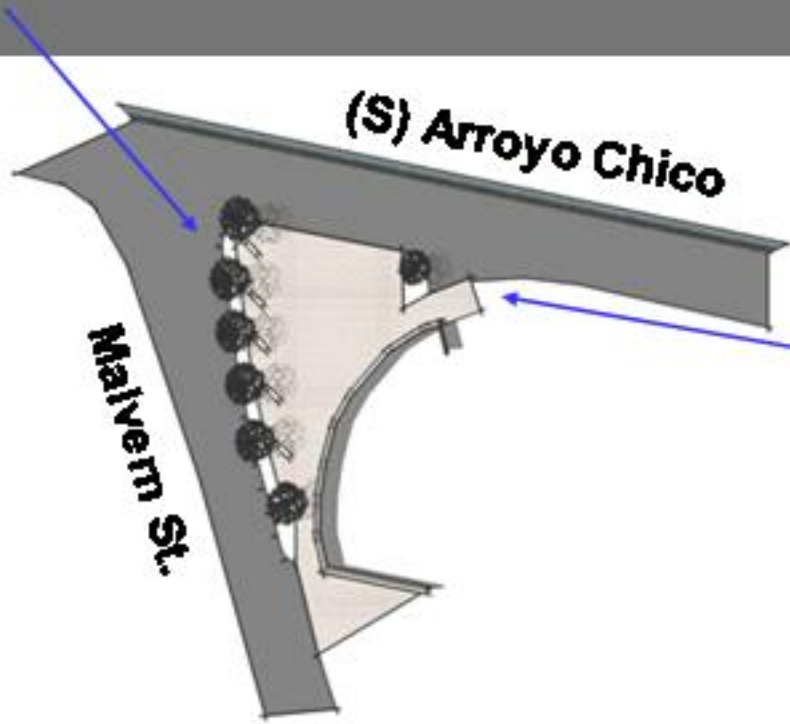

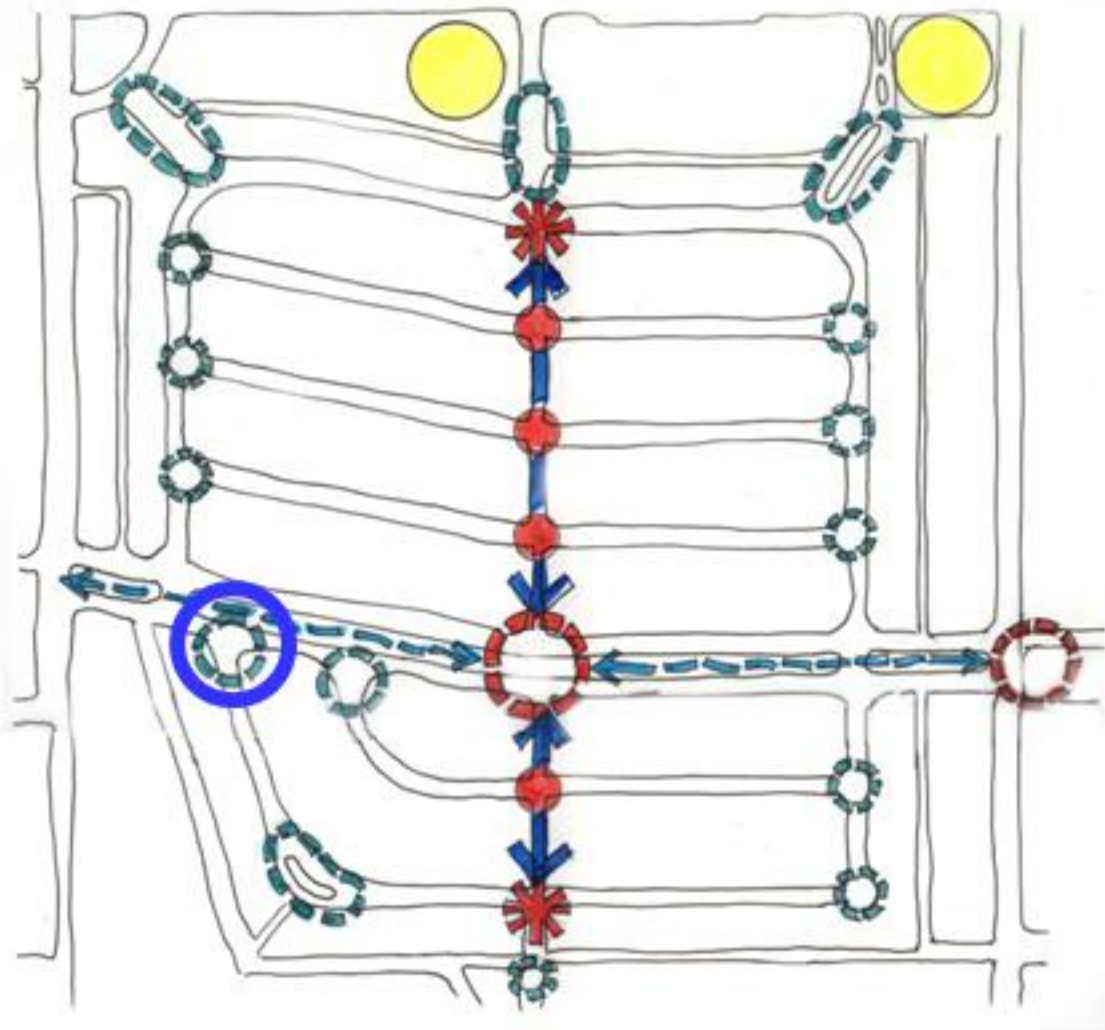

# Gathering Place – E. Stratford



